



※ Features:

1. Package: 5.3*5.0*1.8mm (TOP view infrared LED)
2. Emitted Color: Infrared
3. Mono-color type
4. Soldering methods: All SMT assembly methods
5. Comply ROHS standard.

※ Applications:

1. LCD back light.
2. Mobile phones: LCD.
3. Status indicators: Consumer & industrial electronics.
4. General use.

※→Package Outline Dimension:

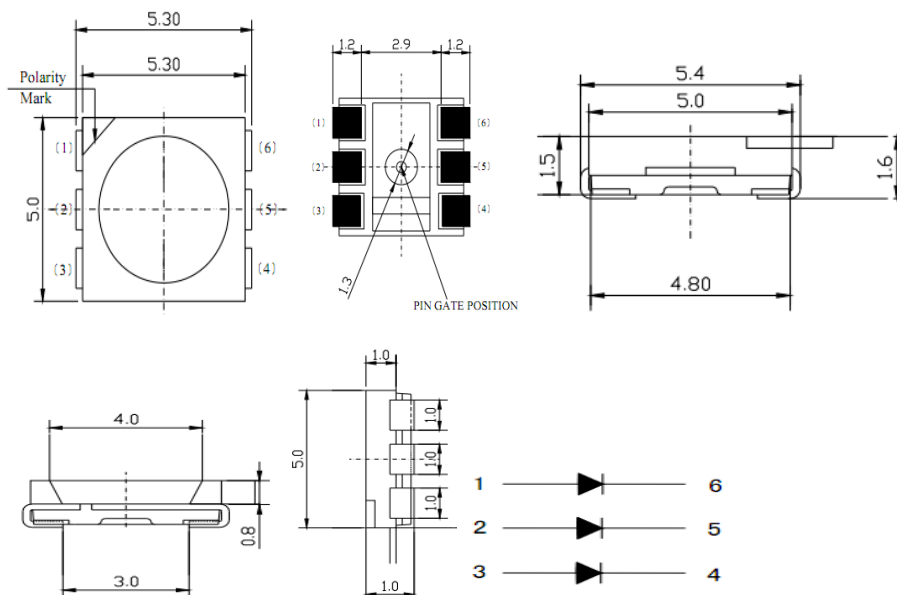

1. All dimensions are in millimeters (inches).
2. Tolerance is ± 0.10 mm unless otherwise specified.
3. Specifications are subject to change without notice.

※ Absolute Maximum Ratings(Ta=25°C)

Parameter	Symbol	Rating	Unit
Power	Dissipation	Pd	200 mW
Forward	Current	IF	60 mA
Peak Forward	Current * 1	IFP	150 mA
Reverse	Voltage	VR	5 V
Soldering Temperature	Tsol	260 (for 5 seconds)	°C
Storage -	Temperature	Tstg	-40°C~85°C
Electrostatic	discharge ESD	2000 V	-
Operating Temperature	Topr	-30°C~85°C	-

* 1 IFP condition: pulse of 1/10 duty and 0.1ms width.

※ Electrical-optical characteristics(Ta=25°C)

Parameter	Symbol	Min	Typ.	Max.	Unit	Condition
Forward Voltage	Vf	3.2		3.6	V	IF=60mA
Luminous Intensity	Lm	390		400	lm	
Luminous Intensity	Iv	20		40	mcd	
Viewing Angle	2θ1/2				deg	
Reverse Current	IR	-	-	10	μA	VR=5V

. Note: 1. Tolerance of luminous intensity is ±10%

2. Tolerance of forward voltage is ±0.05V

※ Typical Electro-Optical Characteristics Curves

